



# WonderTrek

CHILDREN'S MUSEUM

**WonderTrek's Outdoor Adventure**

# Sponsorship Catalog

**Nine acres of outdoor discovery, play, and belonging sparking imagination,  
the joy of play, and the wonder of learning.**

**OPENING 2026 | BAXTER, MN.**



*"Lake Country's New Gateway to Play"*

OPENING IN 2026

# The Wait is Almost Over

**AT WONDERTREK, WE BELIEVE PLAY AND EXPLORATION AREN'T OPTIONAL — THEY'RE ESSENTIAL.**

Through play, children learn to collaborate, think creatively, persevere through challenges, and discover who they are. Play builds more than wonderful memories—it helps build resilient, confident people.

**WonderTrek's Outdoor Adventure** is nine acres of fenced-in freedom designed to restore the kind of hands-on discovery that naturally comes from outdoor play. Thoughtful planning and design make it easy for parents and guardians to feel confident as children safely explore, take risks, and follow their imaginations.

After ten years of dreaming and planning, that vision is becoming reality. **In 2026, WonderTrek's Outdoor Adventure will open as a one-of-a-kind children's museum built entirely for exploration.**

Thanks to visionary donors and dedicated grant partners, more than **\$6 million** has already been raised. Now we are entering the final stretch. Your support will help bring the exhibits to life and provide the tools, structures, and spaces that will keep children playing from sunrise to sunset—and beyond.

To cross the finish line, we're inviting everyone who wants our region to be the best place to raise a family to be part of this effort. Every gift moves us closer to opening day.

**Join the campaign  
and help us build a  
world of wonder.**

*We would love to build this with you!*



# WonderTrek Outdoor Adventure Sponsorship Catalog

## Table of Contents

### Welcome and Vision

- Welcome to WonderTrek Outdoor Adventure ..... 2
- Mission and Vision ..... 5

### Sponsorship Overview

- How a Sponsorship Works ..... 6
- Recognition and Benefits ..... 6
- Sponsorship Levels Overview ..... 6



### Visionary Level (\$100,000+)

- WonderTrek Outdoor Adventure \$1,500,000 ..... 7
- Treehouse and Play Path for All \$1,250,000 ..... 8
- Adventure Outfitter Studio \$1,000,000 ..... 9
- Water on the Move \$250,000 ..... 10
- Trail Hub and Adventure Trails Reserved ..... 11
- Roots and Rigging \$100,000 ..... 12
- Play Pavilion \$100,000 ..... 13



### Leadership Circle (\$40,000-\$99,000)

- Cornerstone Founder Opportunities \$25,000 ..... 14
- Children's Gardens Reserved ..... 15
- Minnesota's Longest Picnic Table and Courtyard \$75,000..... 15
- Water on the Move: Stream and Delta \$95,000..... 16
- Mud! \$40,000 ..... 16
- Water on the Move: Pond and Dock \$95,000 ..... 17
- Stormwater Infiltration System \$50,000 ..... 17



### Benefactor Level (\$10,000-\$39,000)

#### Adventure Outfitter Studio

- Outfitters Station Reserved ..... 18
- Outfitters Workshop \$25,000 ..... 19
- Outfitters Play Porch \$15,000 ..... 19
- Timber Wall \$10,000 ..... 19
- Family Restrooms \$10,000 ..... 20
- First Aid Station \$10,000 ..... 20
- Outdoor Clean-Up Stations \$10,000 ..... 20

## Gathering and Cmapus Features

- Gathering Hearth \$25,000 ..... 21
- Rest and Recharge Stations \$10,000 ..... 21

## Roots and Rigging

- Zip Lines \$12,000 ..... 22
- Building Starter Stations \$10,000 ..... 22
- Circular Platform with Access Ramp \$15,000 ..... 22
- Balance Beams and Ropes \$10,000 ..... 23
- Program Pavillion \$15,000 ..... 23
- Stump Climber Bridge \$15,000 ..... 23
- Accessible Cookie Climber Platform \$15,000 ..... 24
- Hyperdome \$12,000 ..... 24
- Rickety Slat Bridge \$10,000 ..... 24
- Balance Logs \$10,000 ..... 25

## Additional Experiences

- Boomerang Berm \$25,000 ..... 25
- Recreation Dock and Paddle Station \$25,000 ..... 25



## Community Partners (Under \$10,000)

### Adventure Outfitter Studio

- Adventure Backpacks \$250 ..... 26
- Creativity Cabinets \$2,000 ..... 27
- Worktables \$1,500 ..... 27

### Water on the Move

- Stream and Play Tool Rack \$3,000 ..... 27

### Trail Hub and Outdoor Elements

- Engraved Benches \$3,000 ..... 28
- Engraved Tables \$1,500 ..... 28
- Trees with Placards (Limited Availability) \$500 ..... 26

### Legacy Giving Opportunities

- Engraved Pavers \$200 ..... 28
- Engraved Bricks \$100 ..... 28



## Ways to Get Involved

- Pledge Card ..... 29

# Priority Needs for 2026 Opening

(A)



Adventure Outfitters Studio

(C)



Mud!

(K)



Water on the Move

(I)



Roots and Rigging

## OUTDOOR PLAY MATTERS

We envision a vibrant and connected community where all children have supportive relationships, meaningful opportunities to explore, and the well-being they need to thrive. WonderTrek will provide a place where curiosity grows, confidence develops, and families create lasting memories together.



## TIMELINE TO OPEN

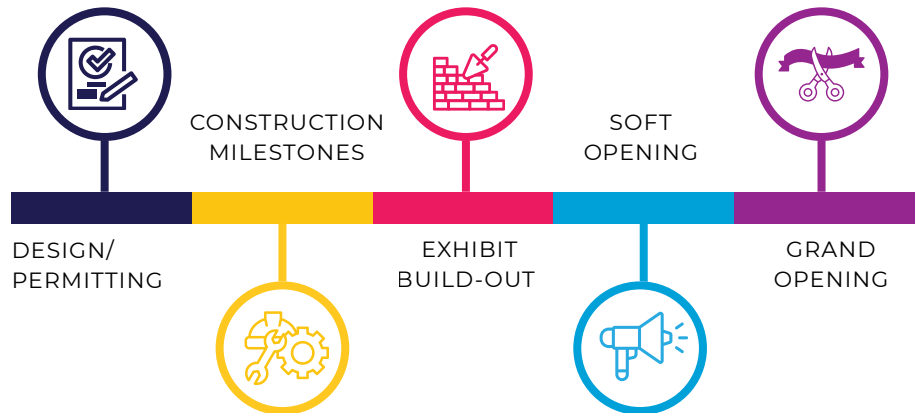

## MISSION STATEMENT

The children's museum brings together the region's children and families in shared experiences that are grounded locally and open into the wider world. Dynamic, material-rich environments, exhibits, events, and programs engage children in the joy of play and the wonder of learning.

# Ways to partner with us...



## VISIONARY SPONSORS

(\$100,000 AND UP)

**Visionary Sponsors** represent the highest level of partnership and commitment. Their leadership investment helps shape the future of the organization and fuels its long-term vision, innovation, and strategic growth. Visionaries play a transformative role in advancing the mission and expanding impact within the community.



## LEADERSHIP CIRCLE SPONSORS

(\$40,000 - \$99,000)

**Leadership Circle** sponsors are key champions of the organization's mission. Their generous support provides strong guidance and stability, helping to drive major initiatives, programs, and community engagement. Leadership Circle members demonstrate a deep commitment to meaningful change.



## BENEFACTOR SPONSORS

(\$10,000 - \$39,000)

**Benefactor Sponsors** make significant contributions that directly support essential programs and services. Their partnership strengthens the organization's ability to deliver impactful work and reach more individuals and communities in need.



## COMMUNITY PARTNERS

(UNDER \$10,000)

**Community Partners** are dedicated supporters who stand with the organization in service to the community. Their contributions help expand outreach, strengthen local connections, and ensure the mission reaches those who need it most. Perfect for families, teams, classrooms, small businesses and in-memory tributes.



## PLEDGE CARD

PAGE 29



*From buying an engraved paver to naming the Treehouse, WonderTrek makes it easy for families, businesses, individuals and foundations to pitch in at the level that works for them.*

At every level, great care is taken to ensure recognition is visible, respectful, and commensurate with the giving level. **Not seeing the right fit? Let's design one for you!**

WonderTrek is a registered 501(c)(3) non-profit corporation in good standing. WonderTrek provides a tax receipt for all donations over \$250.

Sponsorships of \$10,000 and above may be pledged and paid over a period of up to five years. Since we're planning on tens of thousands of hands and feet wandering through on our exhibits, most exhibit sponsorships are recognized for a term of ten years, after which the exhibit or area may be refreshed or redesigned. At that time, original sponsors will be given the first opportunity to renew their sponsorship.



## VISIONARY OPPORTUNITIES (\$100,000 AND UP)

**Visionary sponsors** represent the highest level of partnership and commitment. Their leadership investment helps shape the future of the organization and fuels its long-term vision, innovation, and strategic growth. Visionaries play a transformative role in advancing the mission and expanding impact within the community.

*Exclusive naming rights places your name at the heart of discovery and imagination—aligning your brand with adventure, community impact, and the transformative power of play.*

### WONDERTREK OUTDOOR ADVENTURE

**\$1,500,000**

#### Exclusive Naming Rights

Spanning nearly nine acres across the entire fenced-in campus, WonderTrek's Outdoor Adventure is a one-of-a-kind destination where children run, climb, build, and explore in a thoughtfully designed natural environment. Towering pines, rolling mounds, a flowing stream, tree forts, and hands-on discovery experiences come together to create an environment that encourages curiosity, creativity, and confidence. Through the power of outdoor play, this dynamic landscape inspires exploration and fosters a lifelong love of learning.





**F TREEHOUSE AND PLAY PATH FOR ALL \$1,250,000**  
Exclusive Naming Rights

The Treehouse and Play Path will serve as a signature focal point of the WonderTrek experience—an immersive environment where adventure unfolds at every turn. Designed with structures large and small, this dynamic space invites children to climb, balance, build, and explore as they move along the Adventure Trail. Natural materials, fort-building elements, and hands-on “Roots and Rigging” features inspire teamwork, creativity, and problem-solving, often engaging children for extended, self-directed play.





**A** **ADVENTURE OUTFITTERS STUDIO** **\$1,000,000**  
Exclusive Naming Rights

A dynamic hub for campus-wide events, gatherings, and special programming. Its expansive 2,400 square-foot Workshop offers a wonderfully wide-open space, twice the size of a classroom, perfect for messy, large-scale projects and dozens of enthusiastic participants. Every design element encourages children and families to deeply connect with the outdoors and the exciting natural and constructed features of WonderTrek Adventure. Plus, a surrounding concrete apron, protected by deep overhangs, provides increased accessibility and a practical outdoor space to store tools or safely set aside construction projects until the next day.





**K WATER ON THE MOVE \$250,000**  
Exclusive Naming Rights

"Water on the Move" is WonderTrek's dynamic, hands-on exhibit where children explore water, an essential element. A large, interactive stream table is central to the experience, letting visitors move and direct water across a landscape inspired by our region's watersheds. This play helps children understand natural systems through discovery.

The exhibit features a richly layered environment designed to spark imagination, including whimsical animal costumes for role-playing, artistic murals, and dimensional elements. A quiet canoe nook offers a space for rest and reflection.

"Water on the Move" fosters collaboration, creativity, and resilience as children work together to solve challenges and build confidence. It also strengthens connections to our regional natural systems. As the exclusive naming sponsor, your support fuels curiosity and creates meaningful, lasting connections for every child.



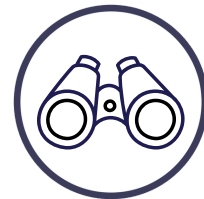

## ROBERT AND RACHEL NYSTROM TRAIL HUB AND ADVENTURE TRAILS RESERVED

We are honored to recognize Robert and Rachel Nystrom for their generous support and exclusive naming of the **Robert and Rachel Nystrom Trail Hub and Adventure Trails**. Their visionary commitment empowers children and families to embark on new journeys, fostering a lifelong connection to the wonders of the great outdoors.





**I** **Roots and Rigging \$100,000**  
Exclusive Naming Rights

Within Roots and Rigging, children discover a hands-on building zone filled with natural materials—logs, ropes, willow branches, and pine boughs—inviting them to climb, create, and construct their own forts. This immersive experience sparks teamwork, imagination, and extended self-directed play, with a nearby zip line adding an extra element of excitement and movement.



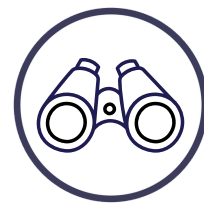

**L** **Play Pavilion \$100,000**  
Exclusive Naming Rights

From celebrating life's moments to gathering the children for lunch to taking in a naturalist program, WonderTrek's Play Pavilion is a specially designed gathering place for families and groups, rain or shine. This 30' x 50' pavilion will be the perfect place to participate in the outdoor classroom. The enclosed backside of the structure is a hub of activity for staff members and volunteers to prepare for smooth operations of WonderTrek's Outdoor Adventure.





## LEADERSHIP CIRCLE (\$40,000 - \$99,999)

**Leadership Circle** sponsors are key champions of the organization's mission. Their generous support provides strong guidance and stability, helping to drive major initiatives, programs, and community engagement. Leadership Circle members demonstrate a deep commitment to meaningful change.

## CORNERSTONE FOUNDER DONATION \$50,000 (Limited to 9 additional Partners)

Donors may choose between restricting their donation to creating an access program for low-income families, jumpstarting phase 2 - the main museum facility, or leaving their donation unrestricted to support areas of greatest need.

**Join our current Cornerstone Founders: Nor-Son Construction; MidMinnesota Federal Credit Union; Essentia Health; National Bank of Commerce; Happy Dancing Turtle; and CTC**



### **A** ADVENTURE OUTFITTERS STUDIO Outfitters Workshop - \$25,000

Designed for everything from messy play and group builds to multi-day facilitated programs. Massive roll-up doors with low thresholds allow the creative space to seamlessly expand outdoors, blending and merging with the natural landscape. With a hose-off concrete floor and easily stowed wheeled tables, the space is always ready to be transformed. Children and families can expect a fresh and different visitor experience with every visit, changing from season to season and day to day.





## B THE GARDENS

Made Possible by The Arwen Avenelle Arts & Activities Fund, these vibrant spaces - from the Pollinator Garden to the Kitchen Garden and Fruit Orchard - invite children and families to explore, grow, and discover the natural world together.



## D MINNESOTA'S LONGEST PICNIC TABLE AND COURTYARD \$75,000

Minnesota's Longest Picnic Table and Courtyard is a great place to gather to relax, eat and get to know your neighbor and new friends. From the bricks and pavers to the connected multifunctional 24 picnic tables it provides physical and symbolic connections between all of the food-related exhibits and the programs at the museum.





### C MUD! \$40,000

Children are invited to mix, stir, and create with glorious batches of mud using bowls, tools, and water from a nearby pump. Whether crafting muddy “treats,” painting with earth, or experimenting with texture, this playful space encourages creativity, cooperation, and hands-on discovery.



### K WATER ON THE MOVE Stream and Delta - \$95,000

A gently flowing stream winds through sand and rock before spreading into a playful delta where children can splash, build dams, and send small boats drifting downstream. With nearby trails and a dock overlooking the pond, this interactive water landscape invites exploration, imagination, and discovery in nature.



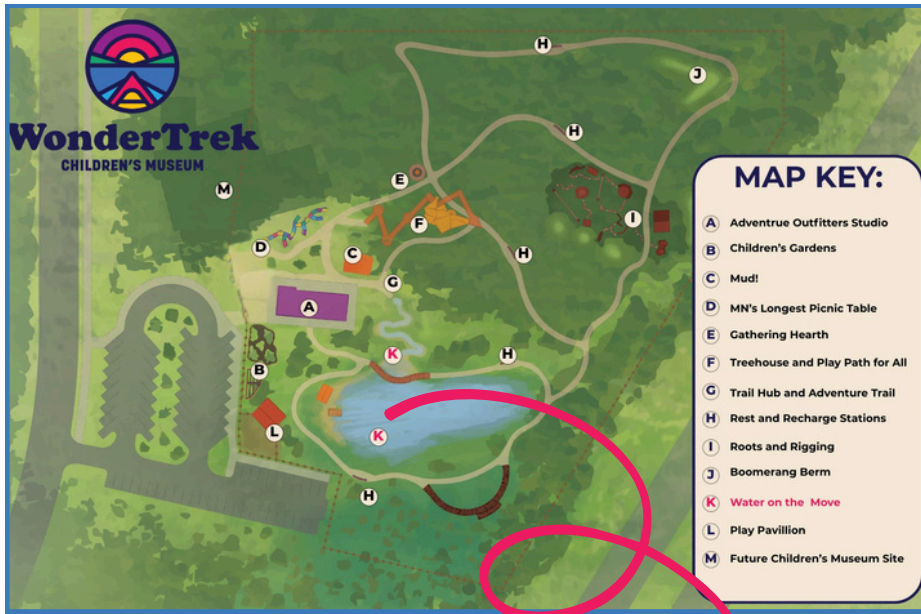

**K WATER ON THE MOVE**  
**Pond and Delta Dock - \$95,000**

A half-acre pond bordered by native shoreline plants creates a vibrant habitat for wildlife and a place for discovery. A gently curving dock extends over the water beside the sandy delta, inviting visitors to explore the pond up close while learning about wetlands and the plants and creatures that call them home.



**K WATER ON THE MOVE**  
**Stormwater Infiltration - \$50,000**

Take a hike on the Outdoor Adventure trail through the Infiltration Basin, encompassing approximately 23,000 square feet, and discover the hidden beauty of an ephemeral pond as you pass shrubs, tall grasses, and blooming forbs. It's a perfect place for exploration, nature immersion, and sparking curiosity about where water comes from—and where it goes.





## BENEFACTOR OPPORTUNITIES (\$10,000 - \$39,999)

**Benefactor Sponsors** make significant contributions that directly support essential programs and services. Their partnership strengthens the organization's ability to deliver impactful work and reach more individuals and communities in need.

A

### ADVENTURE OUTFITTERS STUDIO Outfitters Station Reserved

**Made Possible by Cosmetic and Family Dentistry,** The Outfitters Station was made possible by Cosmetic and Family Dentistry, whose commitment helps children and families to select from an assortment of fun materials, equipment, and activities specifically selected for the season.

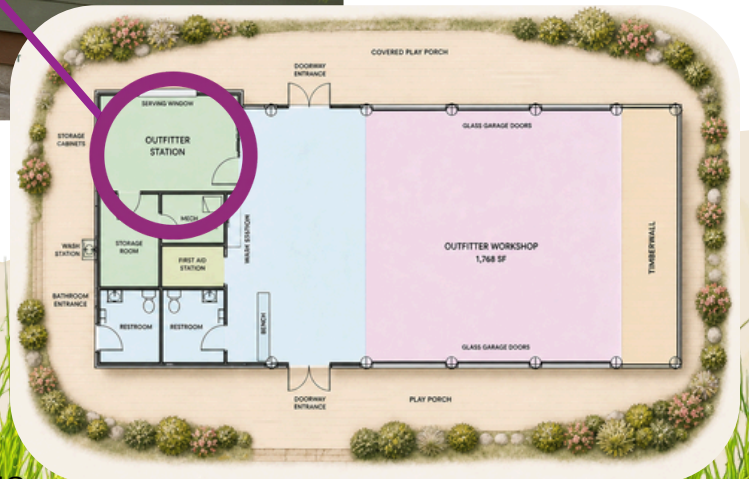



**A ADVENTURE OUTFITTERS STUDIO**  
**Outfitters Workshop - \$25,000**

Designed for everything from messy play and group builds to multi-day facilitated programs. Massive roll-up doors with low thresholds allow the creative space to seamlessly expand outdoors, blending and merging with the natural landscape. With a hose-off concrete floor and easily stowed wheeled tables, the space is always ready to be transformed. Children and families can expect a fresh and different visitor experience with every visit, changing from season to season and day to day.



**A ADVENTURE OUTFITTERS STUDIO**  
**Outfitters Play Porch - \$15,000**

Whether visitors are checking out equipment from the Outfitters Station, taking in a storytelling program, or working on a big messy project, the Play Porch is a multi-module hub of activity. Running along the entire north side of the Adventure Outfitters Studio, the Play Porch provides protection from the elements, creates space for programming adjacent to the Courtyard, and helps transition activities from indoors to outdoors.



**A ADVENTURE OUTFITTERS STUDIO**  
**Outfitters Timber Wall - \$10,000**

Located on the side of the Adventure Outfitters Studio, crafted from vertical northwoods timbers, the Timber Wall invites children to build, create, and imagine on a large scale. With spaces for weaving natural materials and collaborative projects, this ever-changing feature encourages creativity, teamwork, and hands-on exploration.

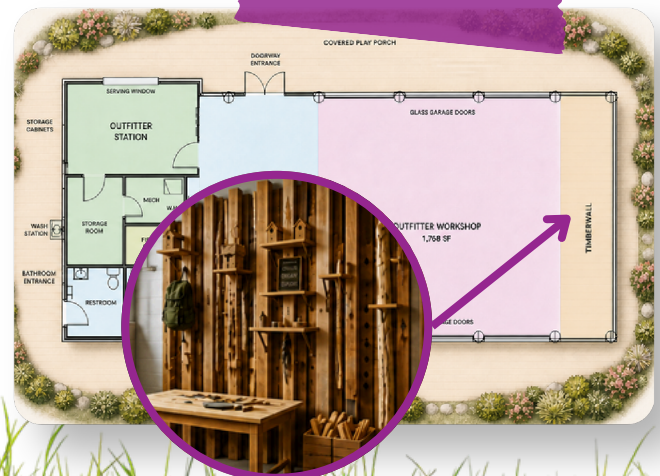



**A ADVENTURE OUTFITTERS STUDIO**  
**Outfitters Family Restrooms - \$10,000**  
 (2 separate opportunities)

Family restrooms will feature child-friendly toilet seats and push-to-flush toilets, multiple hooks to hang clothes and bags, diaper changing stations, and sinks with child-friendly step-up stools. One family restroom will be accessible from the outside and the other from the inside the Adventure Outfitters Studio.



**A ADVENTURE OUTFITTERS STUDIO**  
**Outfitters First Aid Station - \$10,000**

The First Aid Station is a small room just off the Outfitters Workshop, where staff and caretakers can take a child in need of resolving minor injuries or illnesses. It's important that children needing first aid be in a private setting. This room also offers privacy for breastfeeding.

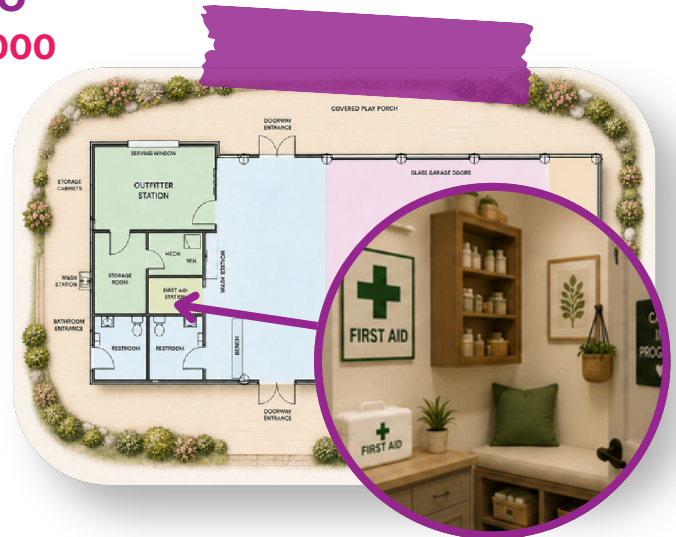

**A ADVENTURE OUTFITTERS STUDIO**  
**Outfitters Outdoor Clean-Up Stations**  
**\$10,000** (2 separate opportunities)

Situated at either end of the Adventure Outfitters Studio, these stations give families a place to wash hands, rinse off, refill water, and regroup after messy outdoor exploration. Thoughtful amenities—including sinks, seating, storage





## **E** GATHERING HEARTH \$25,000

Nestled along the woodland trail, the Gathering Hearth invites children and families to come together around a fire ring surrounded by one-of-a-kind seats crafted by local artists. Whether tending a fire, sharing stories, or simply gathering to play and connect, this welcoming space celebrates warmth, creativity, and community across generations.



## **H** REST AND RECHARGE STATIONS \$10,000 (5 separate opportunities)

Located at five points along the trails, these welcoming stations invite visitors to pause, regroup, and relax. Each location provides seating, shelter from the weather, trail maps, and essential amenities—creating comfortable places for families to rest and for staff to host small programs and activities.





## ROOTS AND RIGGING

- ① **Zip Lines - \$12,000**  
(2 separate Opportunities)

Zipline(s), approximately 30 feet in length, reaching from the heart of Roots and Rigging to a spot close to the main path offers transport and fun for materials versus people, enabling large muscle play. Each of these will have support structure at each end and could have platforms to offer a unique opportunity for another adventure element.



- ① **ROOTS AND RIGGING**  
**Building Starter Stations - \$10,000**  
(2 separate Opportunities)

These stations provide a “starter” point for curiosity, where the provided tools empower children to make choices and take risks in a controlled, natural environment. Partially framed-up four square and A-frame structures offer children an invitation to finish, enlarge, and remodel.



- ① **ROOTS AND RIGGING**  
**Circular Platform with Access Ramp**  
**\$15,000**

This platform, approximately 12 feet in diameter is built safely around a tree, allowing the tree to continue to grow and it is approximately 3 feet above the ground, offering opportunities to build, climb and jump. Young children can access the platform by maneuvering the access ramp.





**I ROOTS AND RIGGING**  
**Balance Beams and Ropes - \$10,000**

Natural suspended log balance beams and rope elements invite children to test their agility, coordination, and confidence as they step, stretch, and steady their way across the course. Designed for active exploration, these playful challenges encourage movement, problem-solving, and perseverance while children build strength and balance through hands-on outdoor play.



**I ROOTS AND RIGGING**  
**Program Pavilion - \$15,000**

The covered pavilion offers a welcoming outdoor gathering space where children and families can rest, learn, and connect with nature. Shaded and open to the surrounding landscape, it serves as a hub for hands-on programs, workshops, and spontaneous discovery—providing a comfortable place for visitors to gather, explore, and experience the joy of outdoor learning together.



**I ROOTS AND RIGGING**  
**Stump Climber Bridge - \$15,000**

This is uniquely designed with universal appeal. Climbing up varied sized stumps is the only way to get up to this bridge, launching countless imaginative play scenarios. This Stump Climber Bridge helps children grow in balance, coordination, and spatial awareness.





## ROOTS AND RIGGING

### I Accessible Cookie Climber Platform \$15,000

Young children practice their climbing skills up stacks of tree cookies to a circular platform that could be wrapped around a tree. A slightly ascending berm provides a accessible route to reach the platform .



### I ROOTS AND RIGGING Hypedome - \$12,000

“Hypedomes”— the 7.5 foot tall and 11.2 foot hexagonal, ultimate cozy cocoon designed for fun and comfort! These rehabilitation stations can be equipped with heat, air conditioning, and stylish furniture. These domes offer the perfect escape for visitors to enjoy playtime during winter's chill or summer's heat. Each spacious “Hypedome” accommodates eight adventurous spirits, making it an ideal place to rest.



### I ROOTS AND RIGGING Rickety Slat Bridge - \$10,000

Step carefully and embrace the thrill! The Rickety Slat Bridge adds a sense of adventure to the Roots and Rigging play area, inviting young explorers to test their balance and coordination as they cross from one side to the other. This wobbly passage sparks imagination, encourages active play, and makes every crossing feel like a small adventure.





**I** **ROOTS AND RIGGING**  
Balance Logs - \$10,000

A series of natural balance logs invites children to climb, step, and test their agility as they move across the course. These playful challenges build coordination, confidence, and imagination while encouraging active outdoor exploration.



**J** **BOOMERANG BERM - \$25,000**

As children roll, climb, stumble, and race across Boomerang Berm, the 12 foot high -100 foot long hill becomes a magical landscape for play. Gentle slopes spark imagination and support sensory development, while the soft grass invites hands-on exploration.



**K** **WATER ON THE MOVE**  
Recreation Dock and Paddle Station  
\$25,000

At a break in the thick fringe of native plants along the pond's northwest shore, a small dock offers safe access to deeper water— perfect for launching small watercraft. Older children can try their hand at maneuvering a child-sized rowboat, kayak, or canoe, supported by WonderTrek program staff who provide safety instruction, participation guidelines, and hands-on assistance.





## COMMUNITY PARTNER OPPORTUNITIES

**Community Partners** are dedicated supporters who stand with the organization in service to the community. Their contributions help expand outreach, strengthen local connections, and ensure the mission reaches those who need it most. Perfect for families, teams, classrooms, small businesses and in-memory tributes.

### WONDERTREK OUTDOOR ADVENTURE

Trees **\$500**

(20 separate Opportunities) **\*\*LIMITED TIME\*\***

Having a tree planted is an excellent opportunity to enhance the beauty of the WonderTrek campus. Each tree is a 5 gallon container with an 5-8 foot tree. A placard will be placed with your name in front of the tree.

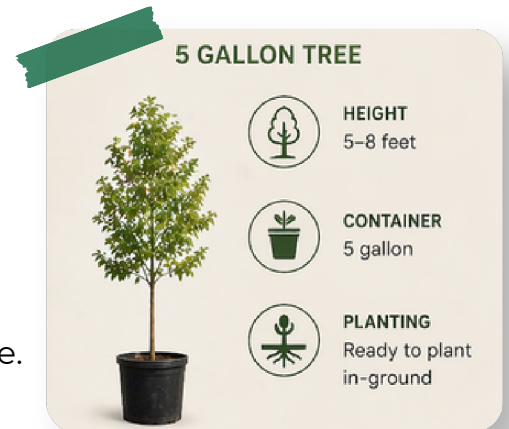

### ADVENTURE OUTFITTERS STUDIO

**Adventure Backpacks - \$250**

(50 separate Opportunities)

An Adventure Backpack is the ultimate way to allow young explorers to carry the magic of play. Each backpack is filled with tools, like a Camp Snap camera (screen-free), magnifying glass, journal, flashlight, compass, gloves, binoculars and other items to spark curiosity and hands-on learning in nature. Each pack helps children explore trails, investigate the forest, and discover the joy of outdoor play.





**A** **ADVENTURE OUTFITTERS STUDIO**  
**Outfitters Work Tables - \$1,500**  
(6 separate Opportunities)

A set of custom work tables will be available for drop-in and organized groups. With solid wood tops, these tables (approx. 4 foot x 6 foot) will be well suited for active construction projects and material exploration. Large, lockable wheels will facilitate various program configurations indoors and outside on the Play Porch.



**A** **ADVENTURE OUTFITTERS STUDIO**  
**Outfitters Creativity Cabinets**  
**\$2,000** (8 separate Opportunities)

Featuring lockable wheels and double doors to secure a range of interior fittings, these rollable units, designed in various shapes and sizes, serve a dynamic purpose within the space. Their finished backs are perfect for temporary display, allowing the cabinets to also be used as versatile room dividers. When a wide- open area is needed, these mobile units can be easily moved to the perimeter or even out to the Play Porch.



**K** **WATER ON THE MOVE**  
**Stream Play Tool Rack - \$3,000**

Located beside the creek, the Stream Play Tool Rack holds shovels, buckets, funnels, sifters, and other tools that invite children to experiment with moving water and sand. With everything close at hand, young explorers can dig, pour, build, and discover how water shapes the landscape through hands-on play.





**D** **MINNESOTA'S LONGEST PICNIC TABLE AND COURTYARD**  
**Engraved Bricks - \$100**  
(Many separate Opportunities)

Personalizing a 4 inch by 8 inch engraved brick for the MN's Longest Picnic Table Courtyard is a meaningful way to leave a lasting legacy. With 60 characters available, you can create a heartfelt, professional, or celebratory message.

**D** **MINNESOTA'S LONGEST PICNIC TABLE AND COURTYARD**  
**Engraved Pavers - \$200**  
(Many separate Opportunities)

Personalizing an engraved 8 inch by 8 inch paver for the MN's Longest Picnic Table Courtyard is a meaningful way to leave a lasting legacy. With 120 characters available, you can create a heartfelt, professional, or celebratory message.

**I** **PLAY PAVILLION PICNIC TABLES**  
**Engraving on a Picnic Table - \$1,500**  
(24 separate Opportunities)

Personalizing an 8-foot by 4-foot tabletop of one of the picnic tables at the play pavilion offers a meaningful opportunity to leave a lasting legacy. With a limit of 96 characters, you can craft a message that is heartfelt, professional, or celebratory.

**G** **TRAIL HUB AND ADVENTURE TRAILS**  
**Engraved Benches - \$3,000**  
(12 separate Opportunities)

Personalizing a 4 inch by 8 inch engraved brick for the MN's Longest Picnic Table Courtyard is a meaningful way to leave a lasting legacy. With 60 characters available, you can create a heartfelt, professional, or celebratory message.

# WonderTrek

## PLEDGE CARD

Name: \_\_\_\_\_

Address: \_\_\_\_\_

City: \_\_\_\_\_ State: \_\_\_\_\_ Zip Code: \_\_\_\_\_

Amount: \$50 \$100 \$250 \$500 \$1,000 Custom Amount: \_\_\_\_\_

Specific Sponsorship Opportunity: \_\_\_\_\_

(i.e. Adventure Outfitters Studio - Outfitters Work Tables - \$2,500)

\_\_\_\_\_ One Time Gift    \_\_\_\_\_ Recurring Gift     Monthly     Annually

### Payment Option:

\_\_\_\_\_ Cash    \_\_\_\_\_ Check    \_\_\_\_\_ Other  
(Stocks, Real Estate, In Kind, Etc.)

\_\_\_\_\_ QR Code online payment option

\_\_\_\_\_ Corporate Match

Name of Company/Contact information



### Personalized Engraving Details:

- Brick (60 characters maximum including spaces)
- Paver (120 characters maximum including spaces)
- Bench (96 characters maximum including spaces)
- Trees (60 characters maximum including spaces)

### Sponsorship Name Display Preference (if applicable):

\_\_\_\_\_

Pledge payments can be accepted for up to five year period for amounts over \$10,000. Please contact Peter Olson to discuss payment schedules, or with questions or to discuss more opportunities to donate.



**Be the spark**

**DONATE TODAY!**



**WonderTrek**  
CHILDREN'S MUSEUM